



DEPARTMENT OF  
ENVIRONMENTAL PROGRAMS

## Worcester County

GOVERNMENT CENTER  
ONE WEST MARKET STREET, ROOM 1306  
SNOW HILL, MARYLAND 21863  
TEL: 410.632.1220 / FAX: 410.632.2012

LAND PRESERVATION PROGRAM  
STORMWATER MANAGEMENT  
SEDIMENT AND EROSION CONTROL  
SHORELINE CONSTRUCTION  
AGRICULTURAL PRESERVATION  
ADVISORY BOARD

WELL & SEPTIC  
WATER & SEWER PLANNING  
PLUMBING & GAS  
CRITICAL AREAS/FORESTRY  
COMMUNITY HYGIENE

March 31, 2025

This notification is to advise you that the Department has received and is presently reviewing the following request for a shoreline construction project:

Brenda Link - Request No. 2025-024 – Request to remove and dispose of existing floating dock and install 4'x15' dock . Max channelward extension not to exceed 4' . This project is located at 420 Ocean Parkway , Berlin, also known as Tax Map 16, Parcel 41, Lot 578 .Third Tax District of Worcester County, Maryland.

The Department in considering this application will make specific findings of fact with regard to the environmental impact, navigational impact, recreational potential, commercial benefit to Worcester County, impact of the proposed construction upon the surrounding neighborhood and upon property values therein, and any other pertinent issues. Approval from the Department does not guarantee approval from any other applicable regulatory agencies.

**If you have an interest which may be adversely affected by the issuance of this permit, you are requested to notify this Department in writing within fifteen (15) calendar days which will end on April 15, 2025.**

Sincerely,

Brandy Whitlock  
Environmental Inspector

cc: Interested Parties  
Joy S. Birch  
File



WORCESTER COUNTY  
SHORELINE CONSTRUCTION  
APPLICATION

Request No.: 2025-024  
Submission Date: 3-31-25

\_\_\_\_\_ Major Construction (\$300.00)

☒ Minor Construction (\$150.00)

**Written Description of Proposed Improvement (include channelward distance):**  
Remove/ Dispose Existing Floating Dock - Install 4' x 15' Dock Max Chnl 4'

**Property Description:**

Map: 0016 Parcel: 0041 Lot: 578 Section: 4 Block: \_\_\_\_\_ Tax District: 03

Street Address: 420 Ocean Parkway Ocean Pines MD 21811

Subdivision: \_\_\_\_\_

Dwelling on lot: \_\_\_\_\_ Dwelling under construction: \_\_\_\_\_ Vacant: \_\_\_\_\_ Commercial: \_\_\_\_\_

**Owner:** Brenda Link Phone No. 302-897-2879

Mailing Address: 131 Brittany Way, Bear, DE 19701

E-Mail Address: ladydunkin@comcast.net

**Contractor:** Ocean City Boat Lifts & Marine Construction Inc Phone No.: 410-352-5095

Mailing Address: 12010 Industrial Park Road Unit 11 Bishopville MD 21813

E-Mail Address: oceancitylifts.kayla@aol.com

**Recorded Adjacent Property Owner:** Donald & Corrie Boger

Property Address: 52 Clubhouse Dr., Ocean Pines, MD 21811

Tax Map: 0016 Parcel: 0041 Lot: 579 Section: 4 Block: \_\_\_\_\_

**Recorded Adjacent Property Owner:** Scott & Linda Reibert

Property Address: 907 Hine Trail, Crownsville, MD 21032

Tax Map: 0016 Parcel: 0041 Lot: 577 Section: 4 Block: \_\_\_\_\_

As the applicant, I attest that the information presented on this application, site plan and any written documentation attached hereto is known to be accurate. I understand that the proposed shoreline improvement will be constructed to meet or exceed minimum design standards adopted by the Department. Any deviation from these standards will require construction plans sealed by an engineer registered in the State of Maryland. I acknowledge that any falsification of information presented may result in revocation of this approval and of the subsequent Shoreline Construction Permit.

Brenda Link 02-10-25  
Owner/Applicant's Signature Date

**DEPT. USE ONLY:**

Notification Distribution Date: 3-31-25 Public Comment Deadline: 4-5-25 (15 calendar days)

Department Approval Date: \_\_\_\_\_ Expiration: \_\_\_\_\_

North Arrow  
→

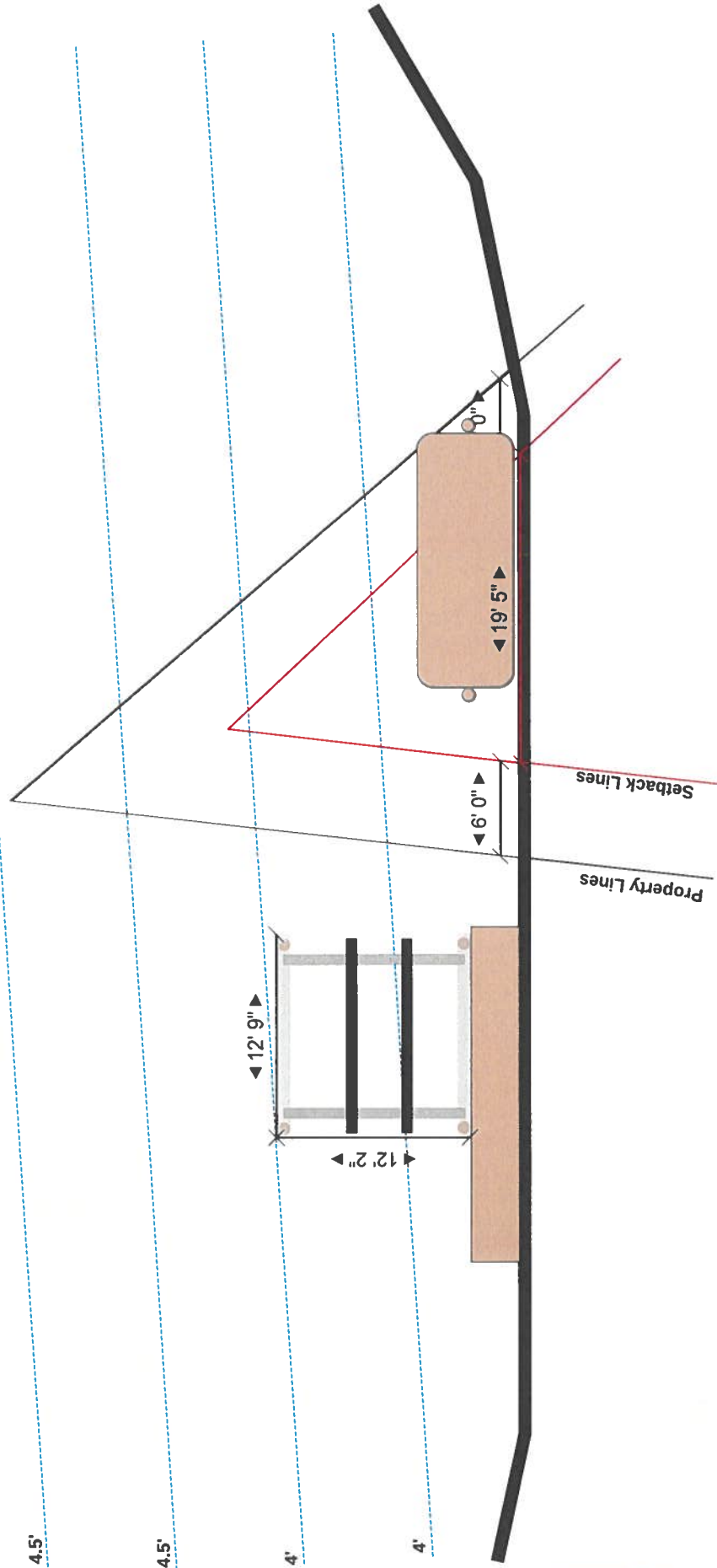

Site:	420 Ocean Parkway, Ocean Pines, MD 21811	Property Owner:	B. Link	Project ID:	24-234	Plan:	Existing	Notes:	Ocean City Boat Lifts (410) 352-5095 oceancitylifts.kayla@aol.com 12010 Industrial Park Rd., Unit 11, Bishopville, MD 21813
Scope of Work:	Remove existing floating dock & Install 5' x 16' Dock	Scale:	1"=10'	Date:	02/03/2025	Contractor:	OC Boat Lifts	-No known SAV -Max Chnl. 6'	

North Arrow

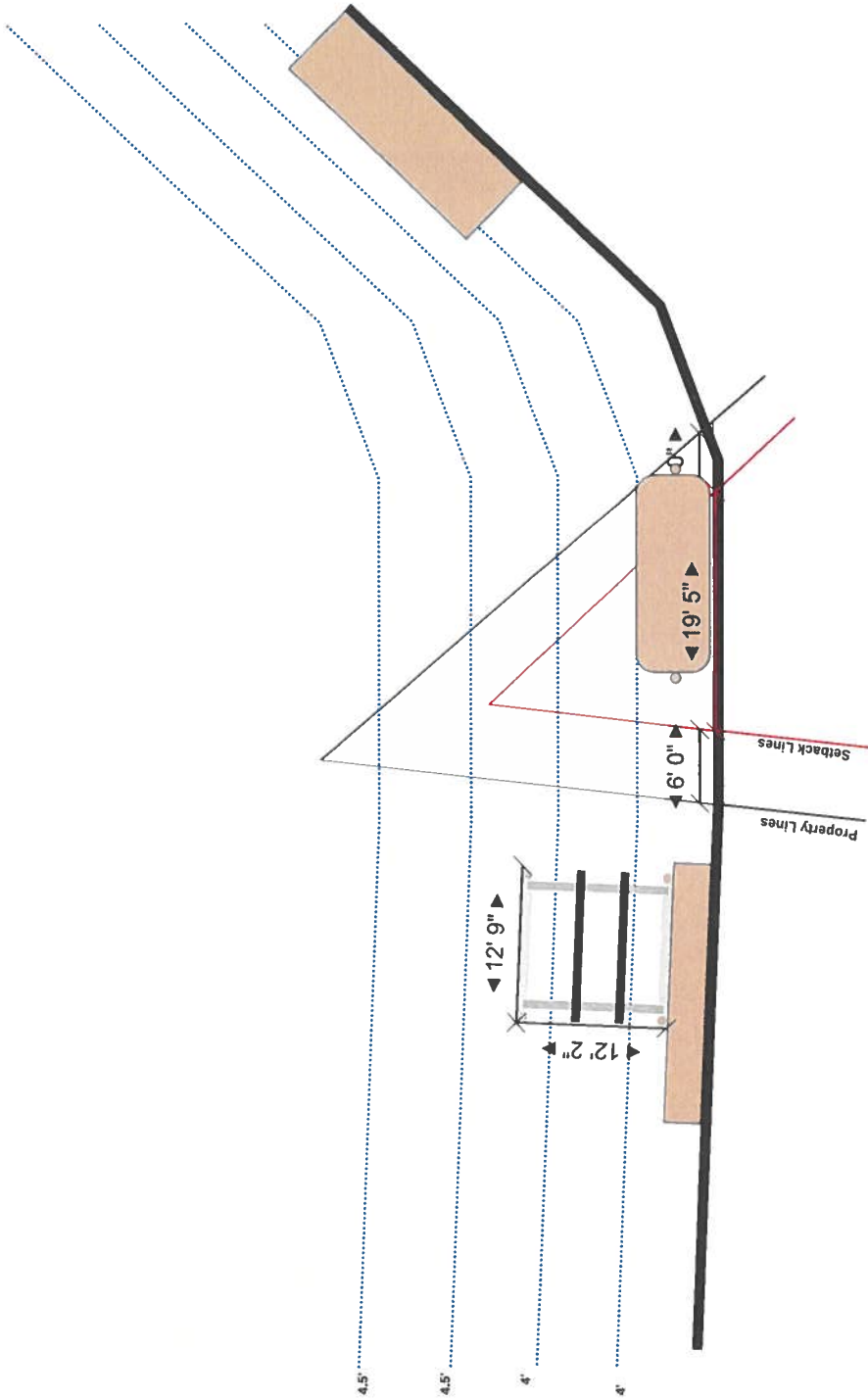

Site:	420 Ocean Parkway, Ocean Pines, MD 21811	Property Owner:	B. Link	Project ID:	24-234	Plan:	Existing	Notes:	-No known SAV -Max Chnl. 6'	Ocean City Boat Lifts (410) 352-5095 oceancitylifts.kayla@aol.com 12010 Industrial Park Rd., Unit 11, Bishopville, MD 21813
Scope of Work:	Remove existing floating dock & Install 5' x 16' Dock	Scale:	1"=15'	Date:	02/03/2025	Contractor:	OC Boat Lifts			

North Arrow  
→

Apx. 206' to opposing shoreline

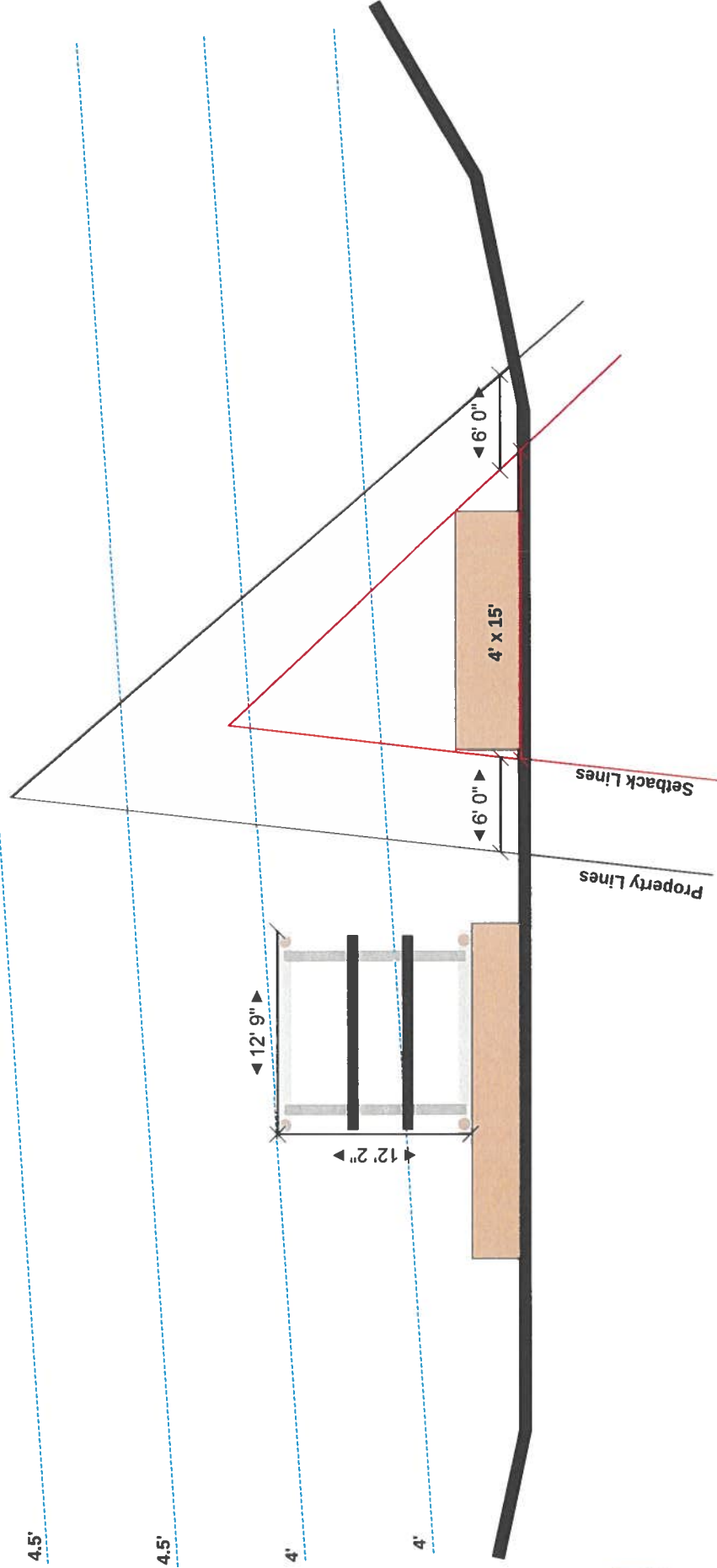

Site:	420 Ocean Parkway, Ocean Pines, MD 21811	Property Owner:	B. Link	Project ID:	24-234	Plan:	Proposed	Notes:	Ocean City Boat Lifts (410) 352-5095 oceancitylifts.kayla@aol.com 12010 Industrial Park Rd., Unit 11, Bishopville, MD 21813
Scope of Work:	Remove existing floating dock & Install 5' x 16' Dock	Scale:	1"=10'	Date:	02/03/2025	Contractor:	OC Boat Lifts	-No known SAV -Max Chnl. 4'	



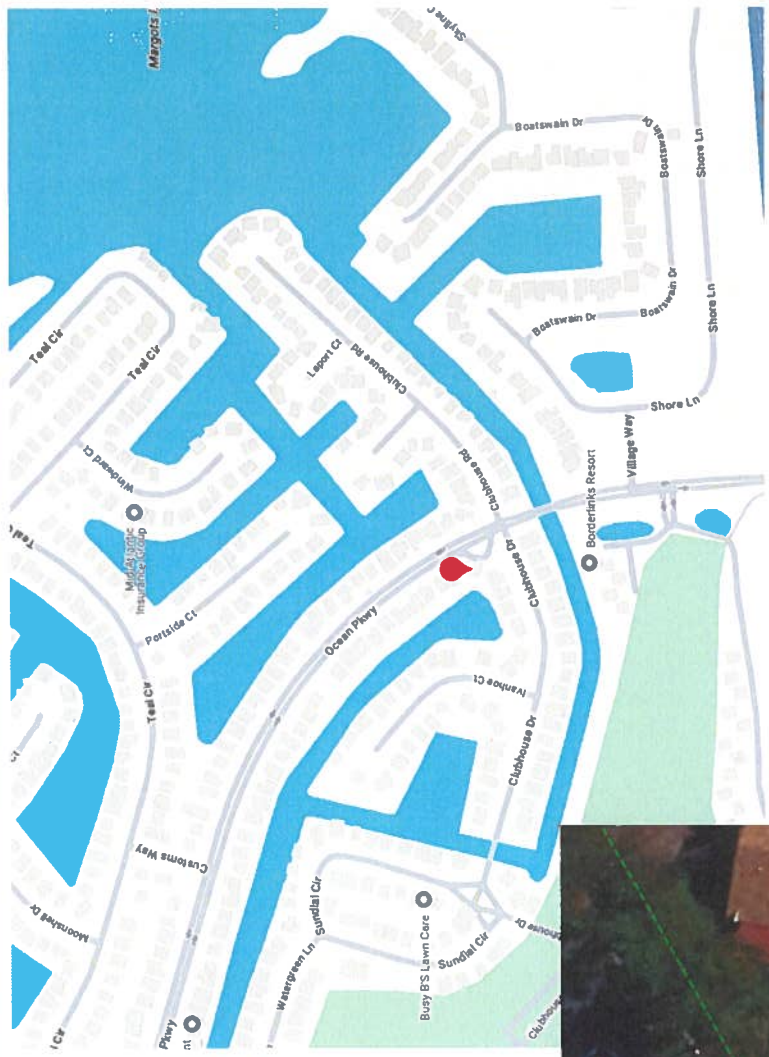
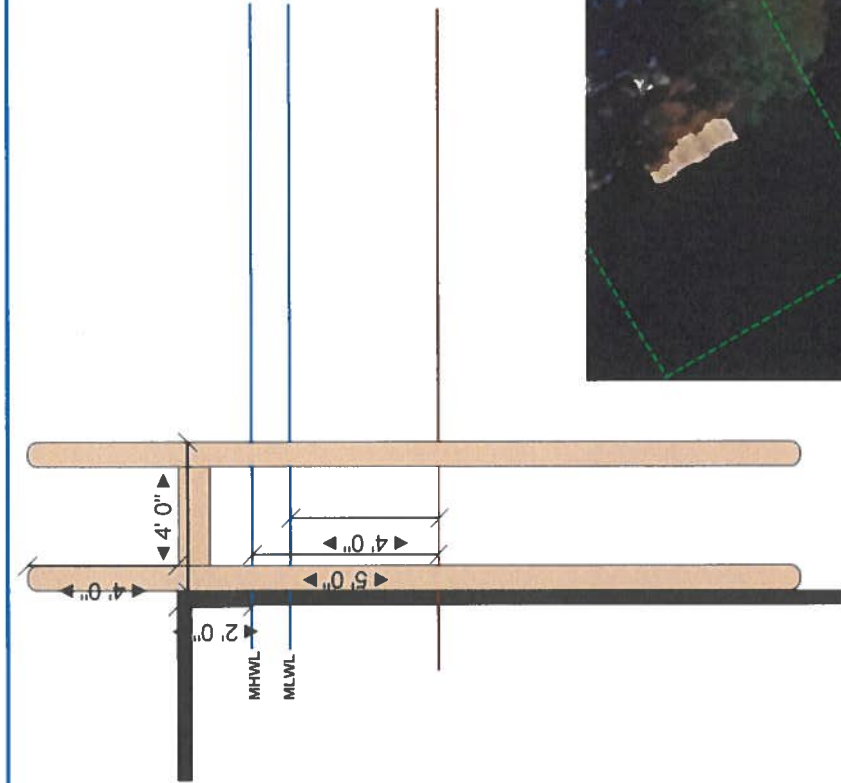

Site:	420 Ocean Parkway, Ocean Pines, MD 21811	Property Owner:	B. Link	Project ID:	24-234	Plan:	Cross-Sec	Notes:	Ocean City Boat Lifts (410) 352-5095 oceancitylifts.kayla@aol.com Unit 11, Bishopville, MD 21813
Scope of Work:	Remove existing floating dock & Install 5' x 16' Dock	Scale:	1"=10'	Date:	02/03/2025	Contractor:	OC Boat Lifts	-No known SAV -Max Chnl. 4'	



